

Inrico®

SINCE 2004

PoC Mobile RADIO

Professional In High Quality Two Way Radios

INRICO TECHNOLOGIES CO., LTD.
www.inricosolutions.com

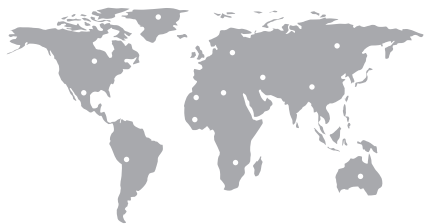

S300

USER GUIDE

Please read this instruction book carefully before using and keep this with care.

www.inricosolutions.com

Notes before using:

- Do not use the walkie talkie in an explosive environment (such as gas, dust, steam, etc.) or to charge the battery.
- Please turn off the walkie-talkie while refueling or parking at the gas station.
- Do not adapt or modify the machine whether there is any reason.
- Do not let the walkie talkie by prolonged direct sunlight, do not place it near a heating appliance too.
- Do not put the walkie talkie at the extremely dusty, damp and splashing place and do not place it on an unstable surface.
- The repair of the walkie talkie only can be carried out by professional technicians, do not disassemble by yourself.

**Note :**

Please read above content carefully. It is very important for walkie talkie users to gain general knowledge and understanding of risk about the use of walkie talkie.

Contents

Unboxing And Device Checking	01
Accessories	01
Preparation Work.....	02
Charging Lithium Battery.....	03
Charging by desktop charger	03
Charging by USB cable	03
Accessories Installation	04
Insert SIM card/Insert TF card.....	04
Install the hang rope/Install the earphone	05
Radio Overview	06
Function Description	07
PTT button/Turn on&Turn off	07
Volume up/down	07
SOS emergency button	07
NFC operation	07
Icon Function Indication.....	08
Indicator Status Description.....	08
Basic Function.....	09
Power on/off	09
Call(initiate a call)	09
Key shortcuts/One-click for photo and video	09
Volume adjustment/Earphone using	09
Low battery reminder/Location report	09
Network Connecting.....	10
Wi-Fi connecting	10
Cellular network connecting	10
Application Management.....	11
Install/uninstall app	11
Clear the application data or cache	12
The non-systematic APP stops running	12
Simple Troubleshooting.....	13
Technical Parameters	14
Physical	14

Unpacking and checking the equipments

Please pull out of the equipments carefully from the packaging box, and we recommend you check the items are listed in the following table before you abandon the package, and make sure you receive all of them. If any items are lost or damaged during the transportation, please contact local dealer immediately.

Accessories:

Items	Quantity
Radio	1
Power Adapter	1
USB-C Cable	1
Screw Driver	1
Hang Rope	1
Card Pin	1
User's Manual	1

Preparation Work

Warning

※ **Do not overcharge with the battery**

Please stop to charge if it is uncompleted in normal time. The battery may flame, smoke or crack due to abnormal charging process.

※ **Do not put battery into the microwave or high pressure container**

The battery may flame, smoke or crack.

※ **Do not expose broken battery to any flame.**

If the battery is seen broken (or with abnormal odor), please remove it from flammable condition immediately. The fluid in battery is really flammable, which may cause flame or smoke.

※ **Do not use abnormal battery**

If the battery is abnormal in odor, color, shape or any other form, please remove it from charger or radio and do not use it anymore.

※ **Please use exclusive adapter**

The adapter in accessories is designed exclusively for the bought radio. It ensures the safety and reliability of battery charging.

Battery Charging:

Feature of the lithium battery:

※ After repeated charging process, the battery capacity will decrease at some certain range.

※ The battery degenerates gradually even without being used.

※ More time will be required when battery charging in the shade place.

※ Charging and storage of Lithium battery in high temperature environment will shorten the service life. Please do not keep them inside the vehicle or near heating equipment.

※ If the duration of battery shortens significantly even its full charged, please contact our distributor for maintenance.

Charging lithium battery

Connect the device with AC adapter and power on, the indicator turns red for working properly.

The indicator turns green when charging finished. The indicator light off and not working when charging temperature exceed the normal operating temperature range, poor contact or battery damage.

Desktop charging:

The desktop charger must be away from the flammable materials/places. Connect the radio and charger according to the direction shown as below, please make sure the Radio working properly and without any damage while charging, do not put the radio into the charger's socket if no need of charging.

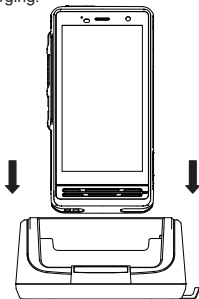

USB cable charging

Plugging the USB-C cable to the radio charging port and another end USB-A interface connect with power adapter LED indicator light on for charging after power supplied .

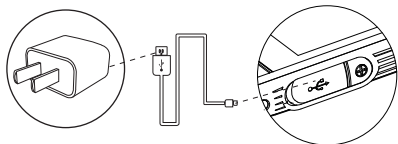

Accessory Installation

To insert a SIM card, TF card

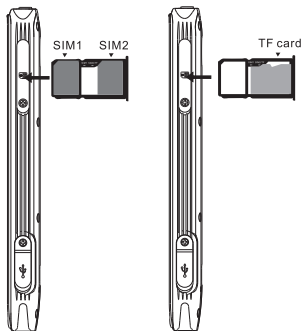

2 Install lanyard

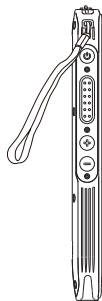

Installing headset



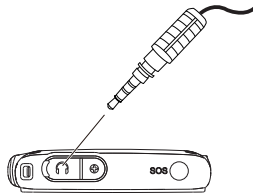

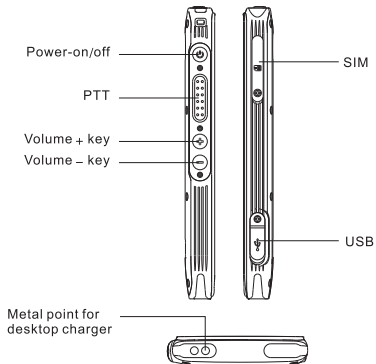
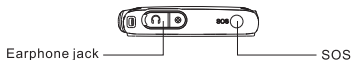
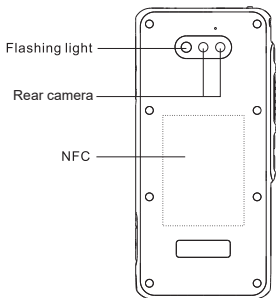
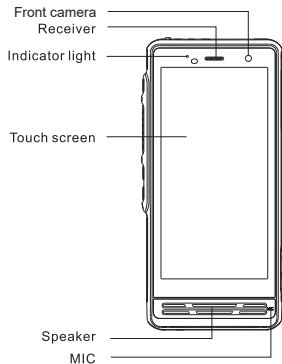

Open the cover from the top of device to show the headset sockets. Headset will work immediately after being plugged in.



Radio Overview



Functions Sheet

No.	Name	Functions
	PTT button	PUSH TO TALK
	Power-on/off	Short press: Lock the screen/screen off Long press: Long press 3 seconds, power on
	Volume + key	Short press: Volume up Long press: Maximum volume
	Volume - key	Short press: Volume down Long press: Minimum volume
 SOS	SOS	Long press: Long press 3 seconds for SOS alarm Press PTT to cancel
	NFC Use	NFC function activated when the screen is on and unlocked

Icon Function Indication

Icon	Function
	The battery is fully charged
	The battery is almost dead
	Network signal icon
	WiFi is turned on, but not connected to the network
	Power saving mode
	Mobile data
	Do not disturb mode setting, Mute/Alarm Only/Priority interruption only three modes optional
	Night mode
	Location information

LED Indicators

Description	LED indicators	
	Color	Status
Charging	Red	On
Fully charged	Red	On

Basic Functions

- **Power - on**
Long press the Power - on / off Key for 3 seconds and wait till the program is started up.
- **Power - off**
Long press the Power - on / off Key for 3 seconds to shut the program. If the device is in the power-charging state, it will flash red light and display the current power capacity.
- **Push to Talk**
Press PTT key to start the call. PTT won't work under busy line. Longest talk time limits in 60s. If exceeds, it will auto release in due time.
- **Shortcut key to fast photograph & video**
 1. Combination key: Press "PTT key" + "Volume + key" to enter / quit video mode. While in the video mode short press "Volume +, - key" to start / end video recording.
 2. Combination key: Press "PTT key" + "Volume - key" to enter / quit photograph mode. While in the photograph mode short press "Volume +, - key" to take the photo.

Network Connecting

Wi-Fi Connecting

After the device is turned on and the main screen shows up, click the "Settings" icon and find the Wi-Fi icon, then click to enter the check box, make sure the right side "On" button been switched on, choose the wireless network you want to connect, enter the password for connecting.

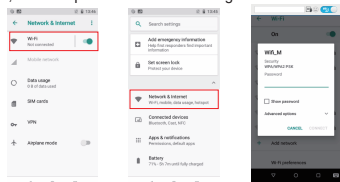

Cellular Network Connecting

Find the "Data usage" in "Settings" and click to enter the check box, switch on & activate the "Cellular data" button, choose the Cellular Network you required.

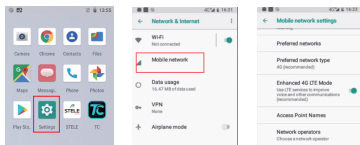

If you are using dual cards, please click SIM cards. After selecting the card you want to set up, you can go online normally.

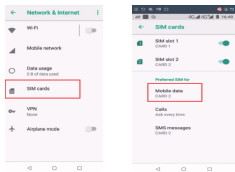

Application Management

After the device is turned on and the main screen shows up, click the "Settings" icon and find the Wi-Fi icon, then click to enter the check box, make sure the right side "On" button been switched on, choose the wireless network you want to connect, enter the password for connecting.

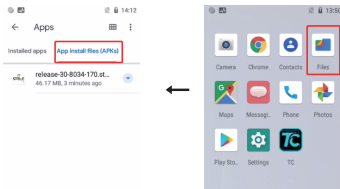

In order to uninstall APP from your device

Follow the steps listed below: Settings -- Apps -- Selecting the App -- UNINSTALL

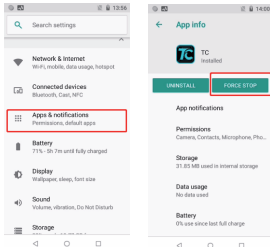

Clear the application data or cache

Settings -- Apps -- Selecting the App -- CLEAR DATA

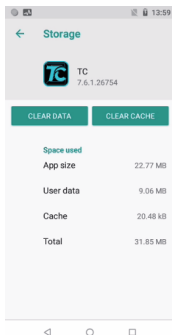

The Non-systematic APP stops running

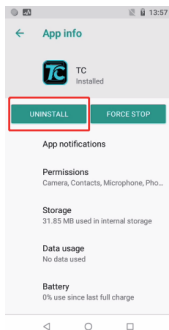

Simple Troubleshooting:

Trouble	Solution
Unable to turn on	The battery may be incorrectly installed. Remove and reinstall the battery.
	The battery might be dead. Charge or replace the battery.
	The battery may not in good condition due to dirt or damage
	Clean the metal contact point pole or replace it
Terminal crash	Program running too much, force stop some running applications or restart the terminal.
Buttons no response	The buttons may not work temporarily, restart the terminal.
	The buttons is broken, contact the dealer or our company
White screen display	Display screen may not work temporarily, restart terminal.
	The display screen is broken, contact the dealer or our company for customer service.
Echo or noise during connecting	The communication signal may be weak, make sure the terminal is within network coverage.
	The speaker may be covered, clean the speaker surface.
Unable to identify SIM Card	The SIM card may be incorrectly installed. Remove and reinstall the SIM card. Sim card may not in good condition due to dirt or damage, clean the metal contact point pole or replace it
Unable to locate	The position signal is weak and the terminal may not be able to receive the signal. Move to an open& flat place and locate it again.
Unable to charge	Power adapter plug may be damaged or poor contacting, pull out and replug the adapter.
	Charging cable connectors may be damaged or have poor contact. Pull out and re-insert the cable.
Short standby time	The battery life becomes shorter in high temperature environment, replaced by new qualified battery. Network Operator problem, power consumption increasing in areas with weak signal , please temporarily turn off the device
Unable to connect the network	SIM card cannot work properly or cannot be used. Make sure the SIM card have balance and not overdue.
	Mobile network is not enabled, switch on the SIM card network and contact the network operator to activate the cellular network.

System Parameter

Operating System	Android	
CPU	MT6739	
Support	BT / WiFi / GPS / NFC	
Camera	Front Camera:5MP Rear Camera:13MP	
Network Frequency	EU	GSM: B2/3/5/8
		WCDMA: B1/5/8
		FDD: B1/3/5/7/8/20/28A/28B
		TDD: B38/B40/B41 (120M)
	US	GSM: B2/3/5/8
		WCDMA: B2/4/5
		FDD: B2/3/4/5/7/8/12/17/28a&b/66
		TDD: B38/40
Screen Size	5 inch	
Screen Resolution	480*960 pixel	
Transmit Power	23dBm~30dBm@-104dBm	
Audio Power Output	2W@10%distortion	

Specification

Dimensions (H x W x D)	156.8*75.7*16mm
Weight	≈ 245g